

HAZ-Wald Farms LLC
hazwaldfarms@gmail.com

Job Corps (13)
(Kis-Lyn)

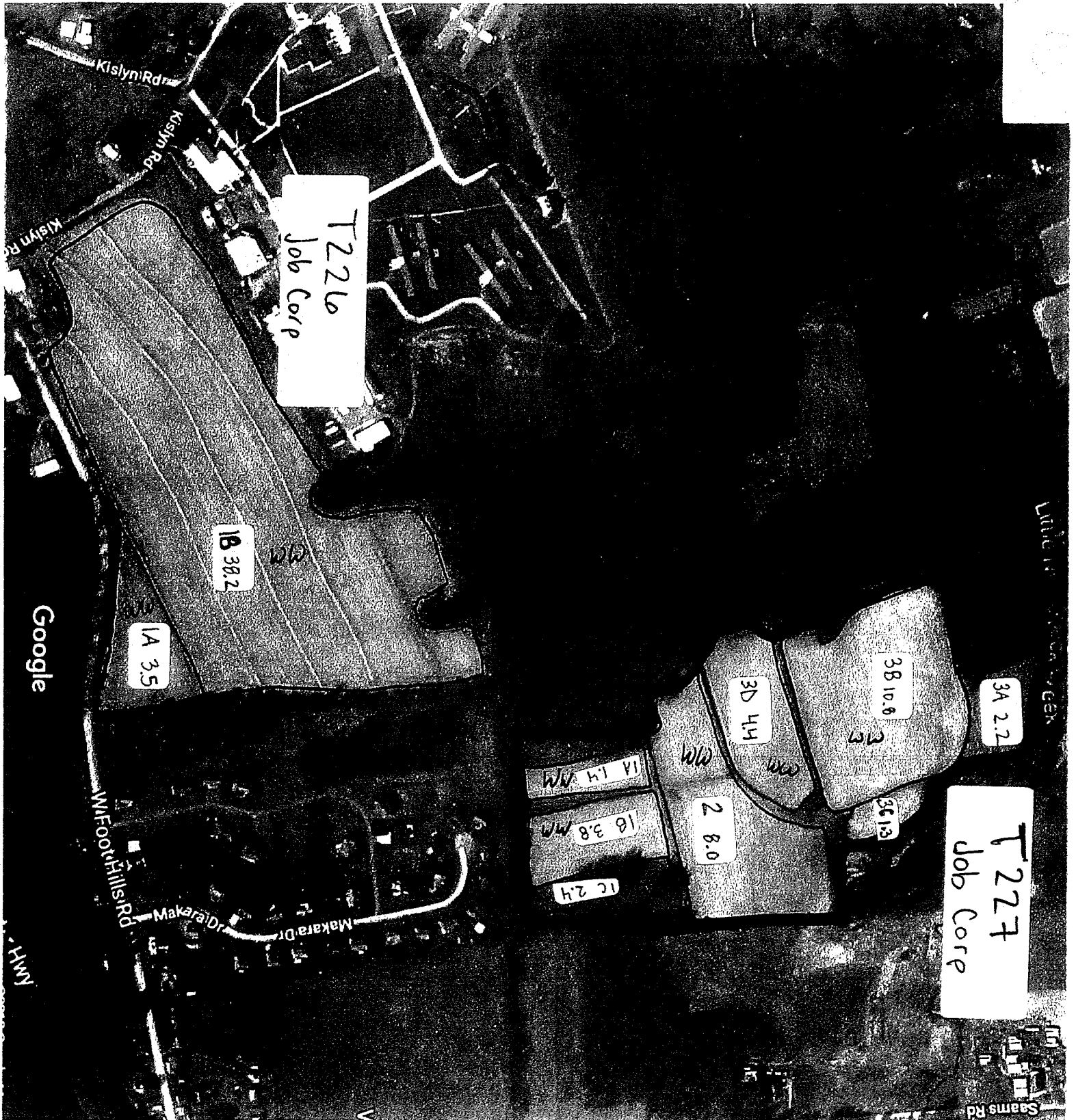

Job Corps (13)

Soil Analysis Report

Report To
 ROSETREE CONSULTING, LLC
 20 GLENBROOK DRIVE
 SHILLINGTON, PA 19607

Prepared For
 HAZWALD

Sampled 11-10-2022
 Tested 11-16-2022

Sample Number	Lab Number	Soil Depth	Depth	Organic Matter %	Proximate Phosphorus	Available Phosphorus	Temperature	Calcium	CEC	Fast-Saturated Flow	Sand %	Silt %	Clay %	Moisture %	Water	Capillary	Permeability	Plasticity	Shrinkage
RARICH 1E	J10679	6.0	6.8	2.2	45 M	105 M	103 M	824 G	6.5	3.5	11.7	47.7							
RARICH 2B	J10680	6.4	6.8	2.1	140 H	125 M	126 M	941 G	7.1	3.8	13.0	49.5							
RARICH 2D	J10682	6.4	7.0	1.5	150 H	150 G	124 M	1018 G	5.0	6.4	18.0	75.6							
FAUST 3D	J10683	5.5	6.8	2.5	246 V	177 G	99 M	673 M	6.0	6.3	12.0	41.8							
FAUST 1A	J10684	6.2	7.0	1.7	82 G	134 G	111 M	670 G	3.6	8.0	22.5	69.5							
FAUST 1D	J10685	6.1	6.9	2.2	95 H	116 M	129 M	980 G	6.0	4.2	15.8	60.0							
FAUST 1F	J10686	5.9	7.0	2.3	114 H	141 G	97 M	902 G	4.4	6.9	18.2	76.9							
FAUST 1G	J10687	6.0	7.1	2.0	87 H	146 G	114 M	1036 G	5.0	6.2	16.6	77.2							
FAUST 1H	J10688	6.1	7.0	2.0	67 G	146 G	82 M	714 G	3.4	4.8	11.2	45.4							
FAUST 2D	J10689	5.6	6.8	2.1	160 V	140 G	95 M	752 G	4.8	4.5	17.5	78.0							
FAUST 1B	J10690	6.5	7.0	1.4	56 M	86 M	132 M	816 G	5.4	3.4	17.9	56.7							
FAUST 3B	J10691	5.6	6.9	2.0	227 V	213 H	98 M	682 G	4.9	9.3	14.8	51.8							
JOB CORP 1A	J10692	6.6	7.1	1.5	67 G	100 M	150 G	1100 G	6.8	3.2	16.2	60.7							
JOB COR FRONT1A	J10693	6.5	7.3	1.7	185 V	135 M	160 G	1420 G	8.7	3.3	13.5	61.3							
JOB COR FRONT1B	J10694	6.4	7.2	1.8	105 H	121 M	138 G	1206 H	5.8	4.5	17.5	78.0							
JOB CORP 2	J10695	6.5	7.2	1.4	107 H	120 M	134 M	1177 G	5.1	3.6	13.6	80.9							
JOB CORP 3B	J10696	6.3	7.2	1.7	135 H	141 G	141 G	1021 G	4.6	4.6	20.3	75.1							
JOB CORP 3C	J10697	6.3	7.2	1.7	57 G	104 M	185 G	1260 H	6.3	3.5	21.5	75.0							
JOB CORP 3D	J10698	6.5	7.2	1.5	80 G	117 M	151 G	1124 G	7.1	3.5	15.5	59.1							
ANTHONY 1B	J10699	6.3	7.1	1.4	29 L	64 M	100 M	813 G	3.9	3.5	18.7	77.8							

* Results: P, K, Mg and Ca are extracted by Mehlich-3 (MCP) and analyzed in ppm
 Ratings: Low-Medium-Good-High-Very High

LLC Checking Haz-Wald Farms

luzerne county tr

Date	Chq...	Payee	Category	Memo	Payment	Cr	Deposit	Amount	Balance
3/8/2023	3471	Luzerne County Treasurer	Rent Paid	2023 Land Rent farmland in Butler Township, Pa	1,400.00	R		1,400.00	-1,400.00
3/1/2022	3094	Luzerne County Treasurer	Rent Paid	Spring Rent 2022	1,400.00	R		1,400.00	-2,800.00
3/22/2021	2537	Luzerne County Treasurer	Rent Paid	Spring Rent 2021	1,400.00	R		1,400.00	-4,200.00
3/15/2020	2006	Luzerne County Treasurer	Rent Paid	Spring Rent 2020	1,400.00	R		1,400.00	-5,600.00
3/15/2019	1456	Luzerne County Treasurer	Rent Paid	Spring Rent 2019	1,400.00	R		1,400.00	-7,000.00
3/17/2018	1067	Luzerne County Treasurer	Rent Paid	Spring Rent 2018	1,400.00	R		1,400.00	-8,400.00
1/8/2018	1001	Comptrol Building & Supply	Supplies, Bus	8610	341.76	R	Deposit	341.76	-8,400.00

6 Transactions

Current Balance 391,913.21

Ending Balance 394,783.91